

Replacement Parts Information

For repairs or routine maintenance, Fill-Rite offers the parts you need. The following parts diagram and list covers all applicable parts for your Fill-Rite product. These parts can be obtained through any authorized Fill-Rite dealer. Be sure to use only genuine Fill-Rite replacement parts for your service and maintenance needs. For a list of authorized dealers, please visit fillrite.com.



WARNING

DO NOT open or attempt to repair the motor on your FR300V series pump. Opening the motor case can compromise the integrity of the Explosion Proof construction and will void any existing warranty and certification (UL listing). Please refer to the Warranty Policy located on page 2.

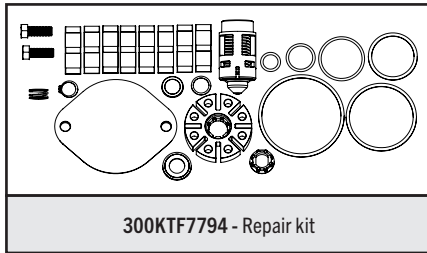

300KTF7794 - Repair kit

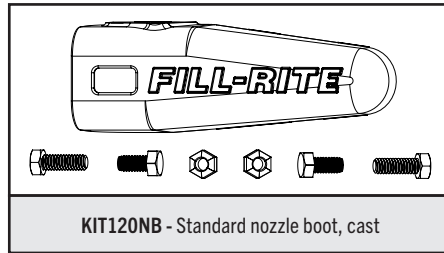

KIT120NB - Standard nozzle boot, cast

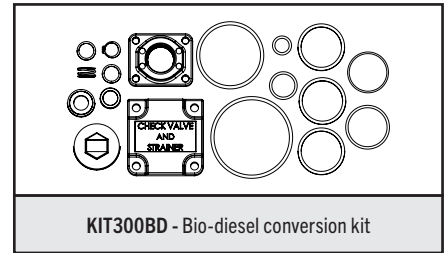

KIT300BD - Bio-diesel conversion kit

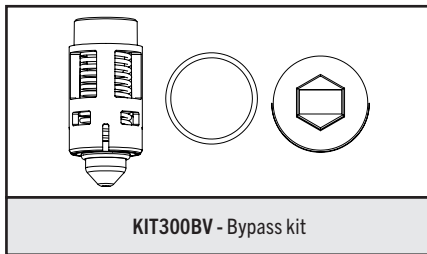

KIT300BV - Bypass kit

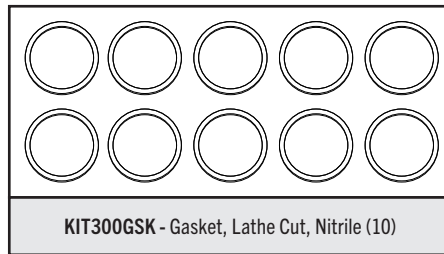

KIT300GSK - Gasket, Lathe Cut, Nitrile (10)

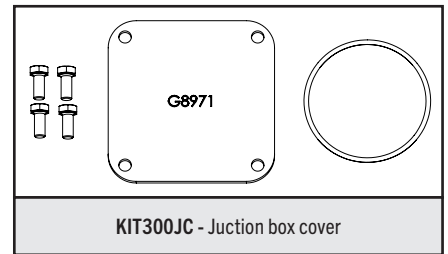

KIT300JC - Junction box cover

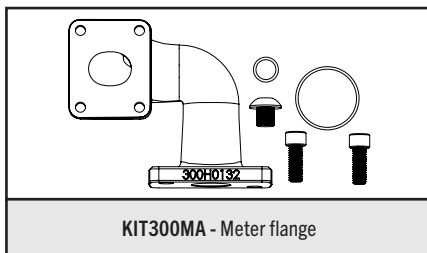

KIT300MA - Meter flange

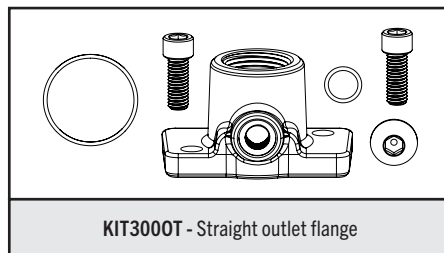

KIT300OT - Straight outlet flange

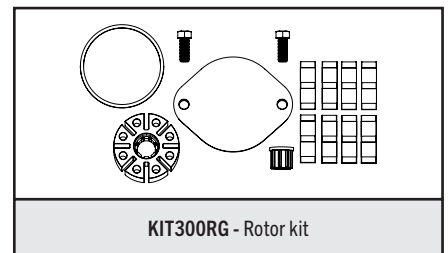

KIT300RG - Rotor kit

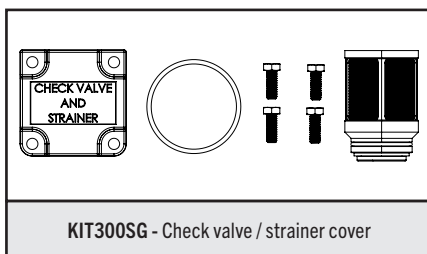

KIT300SG - Check valve / strainer cover

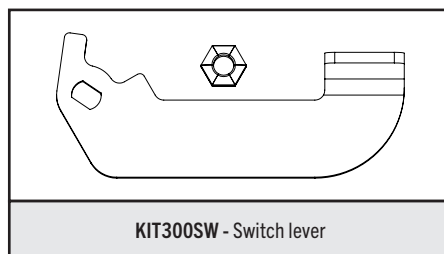

KIT300SW - Switch lever

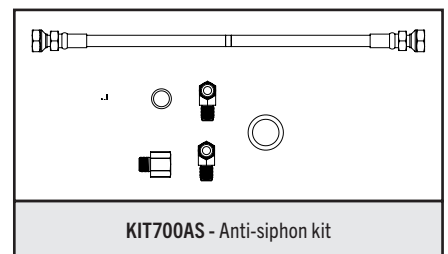

KIT700AS - Anti-siphon kit

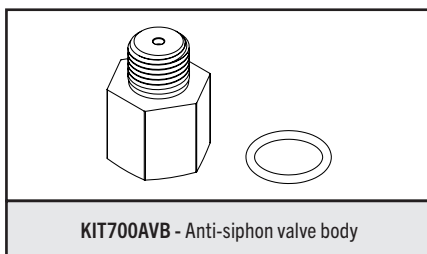

KIT700AVB - Anti-siphon valve body

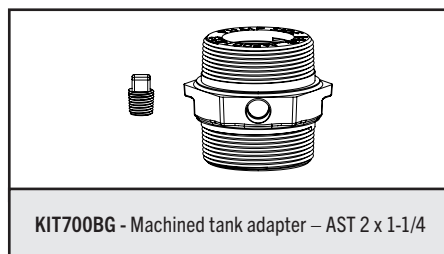

KIT700BG - Machined tank adapter – AST 2 x 1-1/4

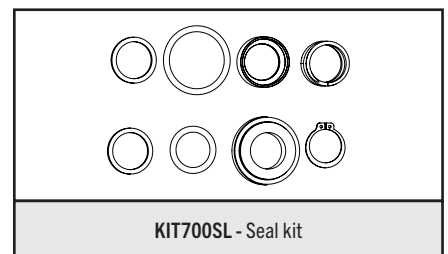

KIT700SL - Seal kit

FR300V / FR310V / FR311V / FR319V Parts List

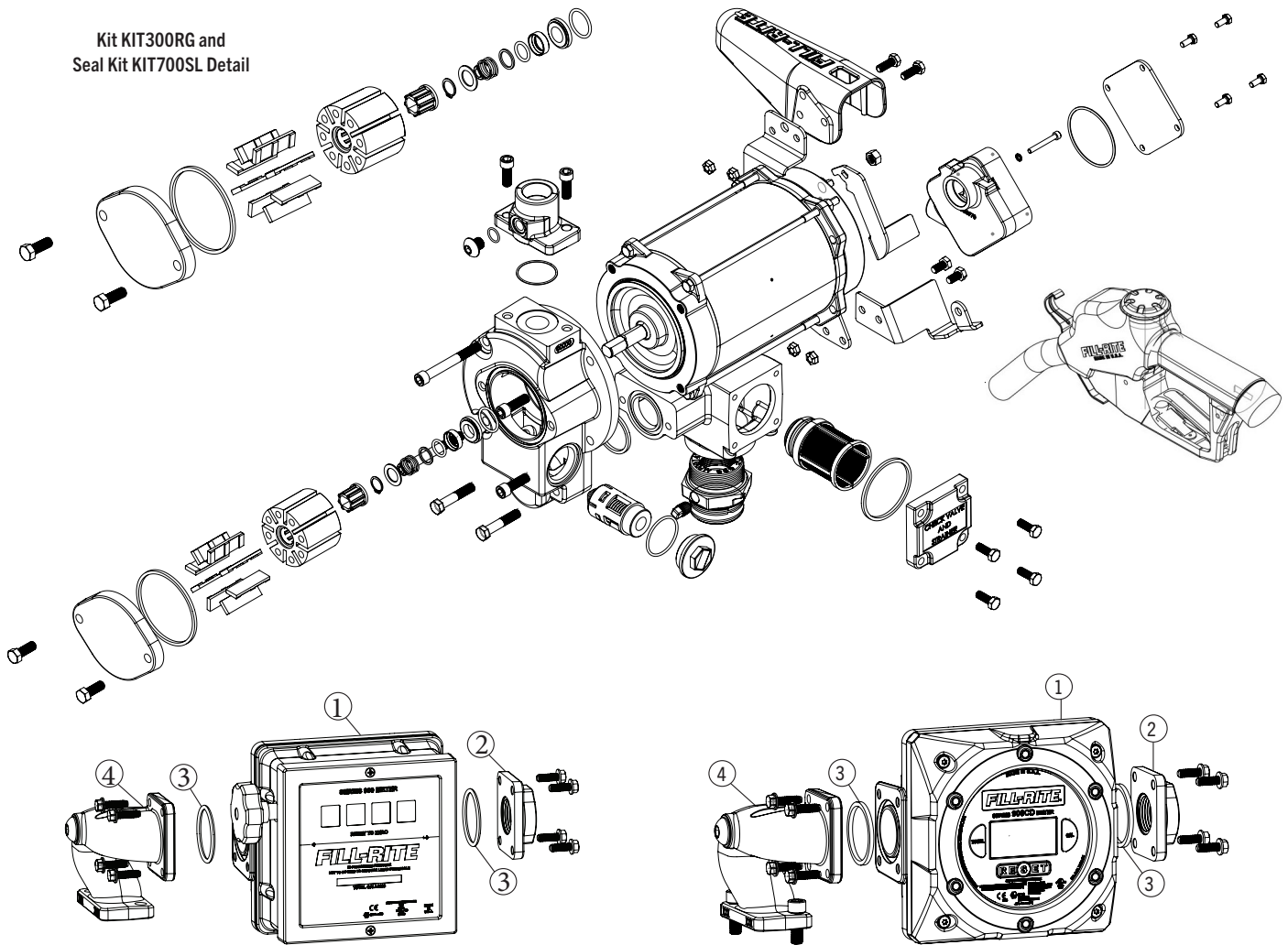

FR311V Parts List

The FR311V configuration adds a 901C Series mechanical meter, inlet meter flange, outlet meter flange, the associated attaching hardware, and gaskets. This package is available in gallon or liter register.

#	Gallon Kit #	Description	Liter Kit #	Qty
1	901C	901C Meter (only) (Gallons)	--	1
2	901C Meter (Gallon) Kit # 901CMK300V	Meter Flange	901CL Meter (Liter) Kit #	1
3		Meter Gasket	901CLMK300V	2
4		1" Meter Fitting		1
1	--	901CL Meter (only) (Liters)	901CL	1

FR319V Parts List

The FR319V configuration adds a 900CD or 900CDP series digital meter, inlet meter flange, outlet meter flange, the associated attaching hardware, and gaskets. This package is available in pulsing or non-pulsing configuration.

#	FR319VB Kit #	Description	FR319VBP Kit #	Qty
--	900CD Digital Meter (no pulser) FR319VB	900CDP Meter	900CDP	1
2		Meter Flange	900CDP Meter w/ integral pulser FR319VBP	1
3		Meter Gasket		2
4		1" Meter Fitting		1
1	900CD	900CD Meter (only)	--	
N/S	--	Intrinsic Safety Barrier*	KIT900DPBA	1

*For use with 900CDP pulsing meter only